



DOUGLAS SQUARE PLAZA

1405-1465 NE Douglas Street, Lee's Summit, MO



LEASE RATE: \$25/SF NNN | 1,658 SF SPACE

DEMOGRAPHICS

	1 mile	3 miles	5 miles
Estimated Population	5,108	49,920	91,508
Avg. Household Income	\$80,530	\$90,267	\$108,503

- Prime Lee's Summit retail/office space for lease
- Great visibility and access to I-470
- Next to B&B Theatres, Applebee's, Whataburger, and more
- I-470 & NE Douglas Street carries over 100,500 cars per day
- Across from Saint Luke's East Health Campus



CLICK HERE TO VIEW MORE LISTING INFORMATION

For More Information Contact:

KARSYN SMITH | 816.412.7372 | karsynsmith@blockandco.com

DAVID BLOCK | 816.412.7400 | dblock@blockandco.com

Exclusive Agents



PHOTOS



SITE PLAN

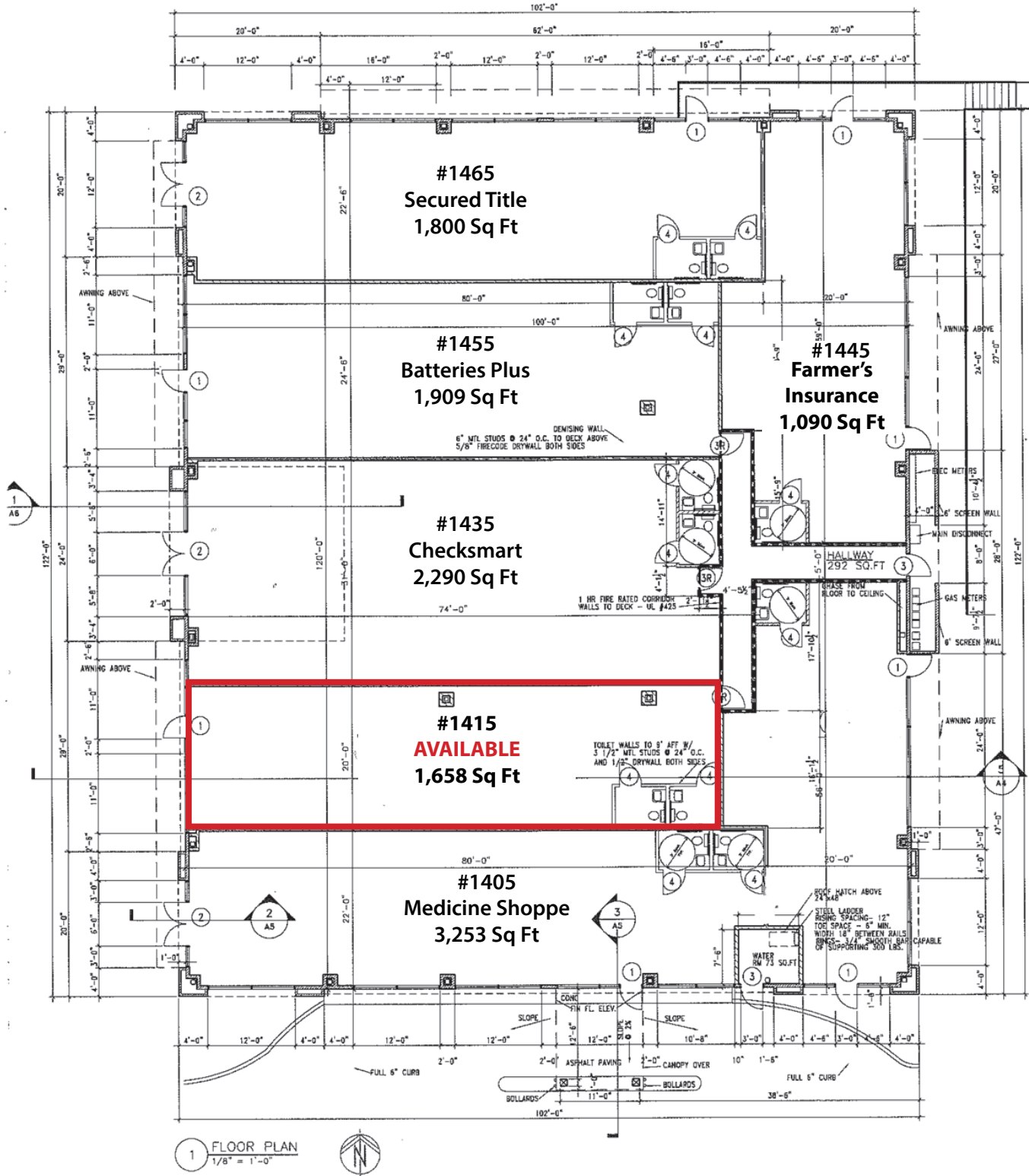

AERIAL





DOUGLAS SQUARE PLAZA

1405-1465 NE Douglas Street, Lee's Summit, MO

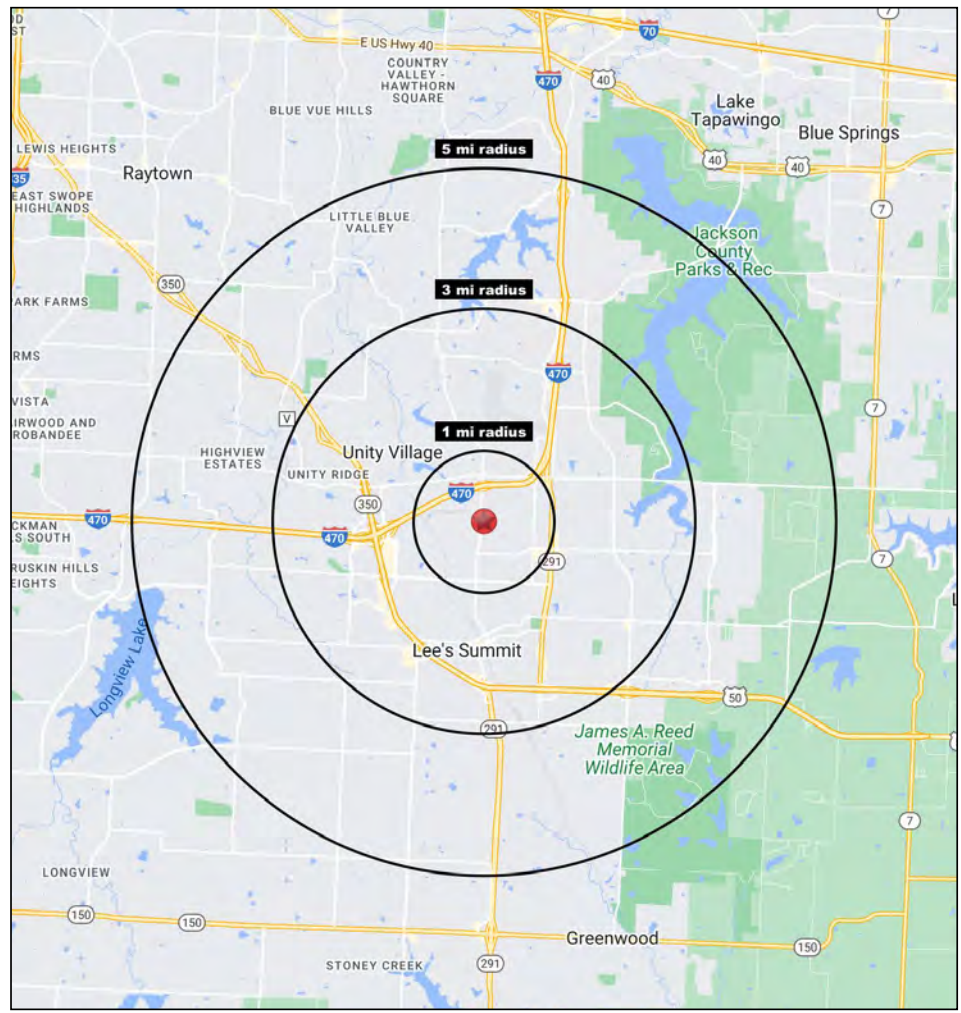
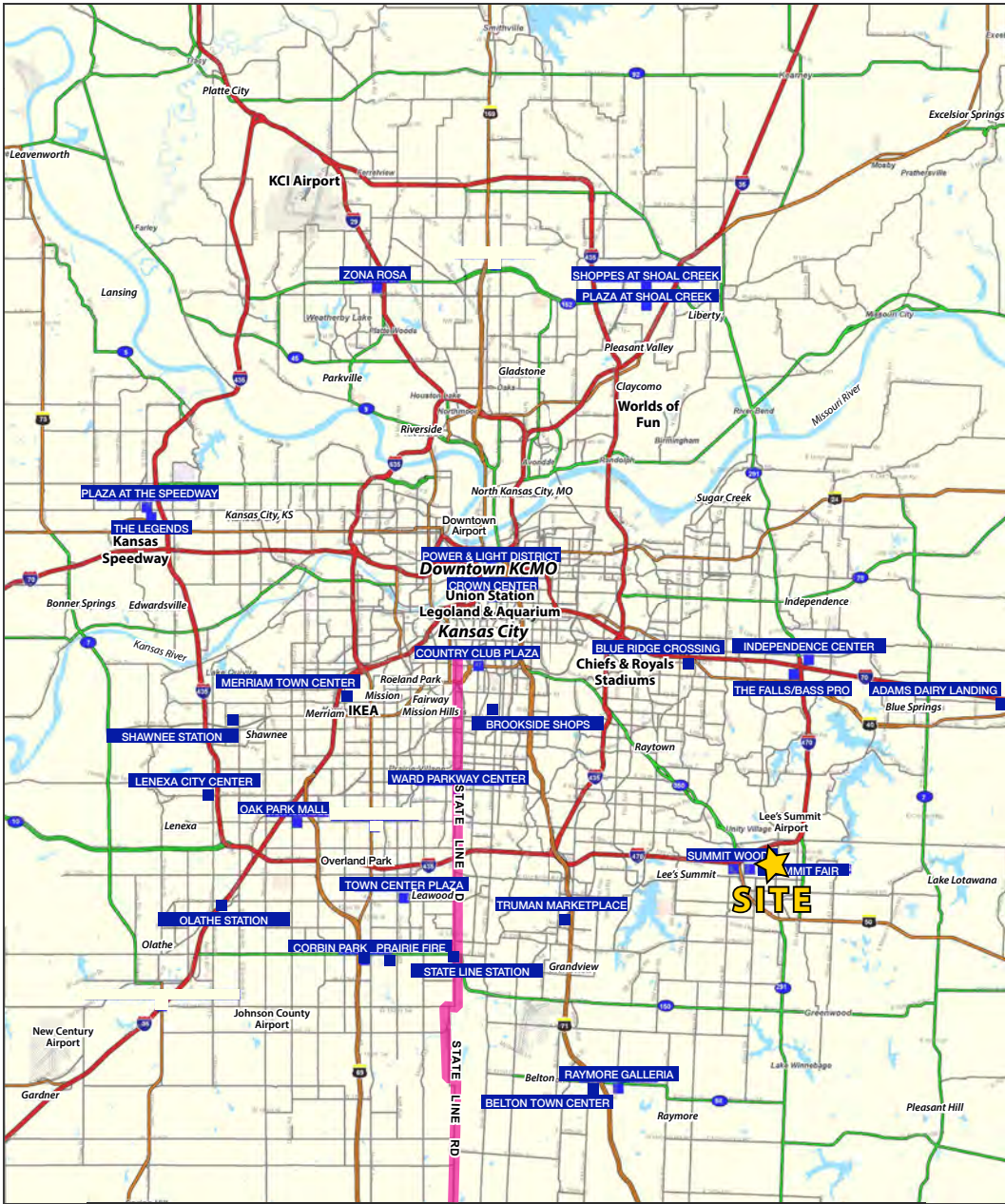



DOUGLAS SQUARE PLAZA

1405-1465 NE Douglas Street, Lee's Summit, MO

1405-1465 NE Douglas Street Lee's Summit, MO 64086	1 mi radius	3 mi radius	5 mi radius
Population			
2022 Estimated Population	5,108	49,920	91,508
2027 Projected Population	5,089	52,238	94,852
2020 Census Population	5,117	49,534	91,379
2010 Census Population	4,596	47,576	83,317
Projected Annual Growth 2022 to 2027	-	0.9%	0.7%
Historical Annual Growth 2010 to 2022	0.9%	0.4%	0.8%
2022 Median Age	36.2	39.5	39.2
Households			
2022 Estimated Households	2,275	20,631	35,694
2027 Projected Households	2,241	21,536	36,823
2020 Census Households	2,262	20,315	35,345
2010 Census Households	1,984	19,165	31,872
Projected Annual Growth 2022 to 2027	-0.3%	0.9%	0.6%
Historical Annual Growth 2010 to 2022	1.2%	0.6%	1.0%
Race and Ethnicity			
2022 Estimated White	72.4%	77.5%	76.6%
2022 Estimated Black or African American	14.9%	12.7%	13.7%
2022 Estimated Asian or Pacific Islander	5.0%	2.0%	2.3%
2022 Estimated American Indian or Native Alaskan	0.4%	0.3%	0.2%
2022 Estimated Other Races	7.4%	7.7%	7.1%
2022 Estimated Hispanic	6.2%	6.2%	5.6%
Income			
2022 Estimated Average Household Income	\$80,530	\$90,267	\$108,503
2022 Estimated Median Household Income	\$61,645	\$76,092	\$89,998
2022 Estimated Per Capita Income	\$35,898	\$37,399	\$42,389
Education (Age 25+)			
2022 Estimated Elementary (Grade Level 0 to 8)	2.7%	2.0%	1.6%
2022 Estimated Some High School (Grade Level 9 to 11)	2.1%	2.4%	2.2%
2022 Estimated High School Graduate	27.4%	23.2%	20.2%
2022 Estimated Some College	13.4%	22.0%	21.3%
2022 Estimated Associates Degree Only	9.0%	9.2%	8.3%
2022 Estimated Bachelors Degree Only	33.5%	26.1%	28.0%
2022 Estimated Graduate Degree	12.0%	15.1%	18.5%
Business			
2022 Estimated Total Businesses	396	2,436	3,595
2022 Estimated Total Employees	5,638	30,288	41,703
2022 Estimated Employee Population per Business	14.2	12.4	11.6
2022 Estimated Residential Population per Business	12.9	20.5	25.5

©2023. Sites USA. Chandler, Arizona. 480-491-1112 Demographic Source: Applied Geographic Solutions 11/2022. TIGER Geographv - RS1

